

PROLINE RTC03-18 PNEUMATIC TIRE CRADLE

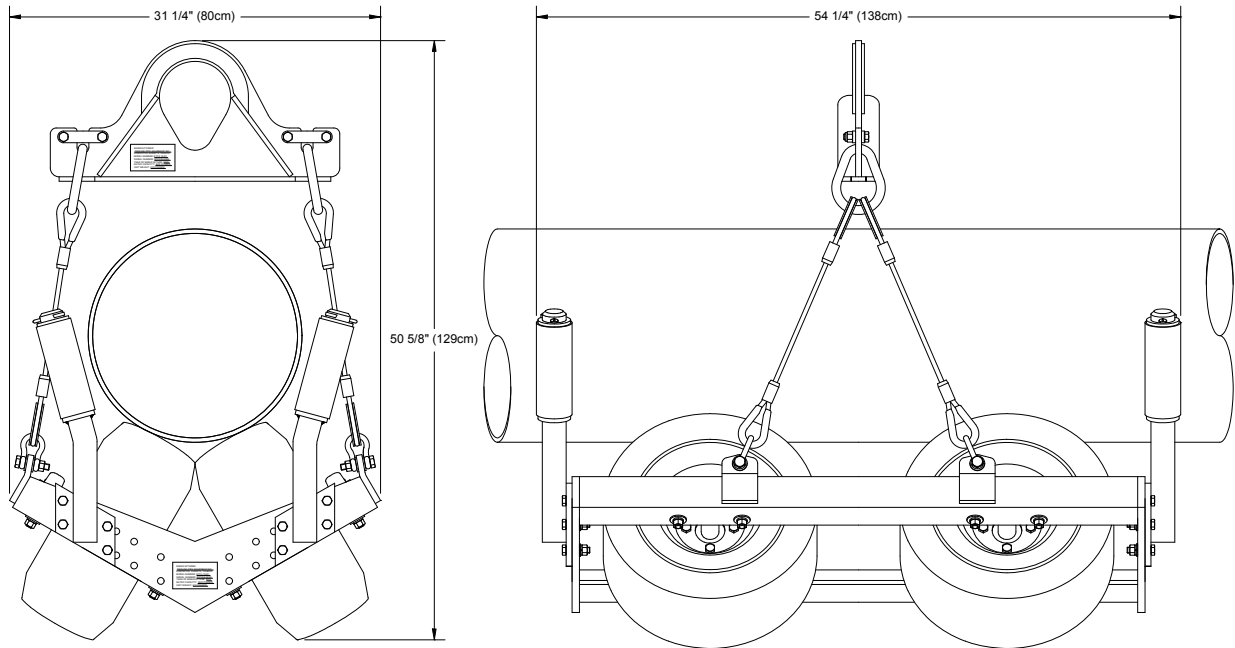

FEATURES

- The Proline RTC03-18 Pneumatic Tired Cradle is designed to support and guide 3” to 18” pipe during pipe handling and lowering-in operations.
- Large multi-ply rubber tires protect all pipe coatings and insulated pipe from damage.
- Guide rollers keep the pipe centered on the four tires and are quickly adjusted for any pipe size within the cradle’s range.
- Wire rope bridle slings allow more versatility for transporting.

SPECIFICATIONS

- | | |
|---------------------------------|---|
| • Pipe size range: | 3 inch nominal (88.9 mm) to
18 inch nominal (457.2 mm) |
| • Quantity of tires: | 4 |
| • Approximate weight: | 510 lbs. (232 Kg) |
| • Recommended max. working load | 3500 pounds |